

Linear guideways

HG/QH series

3.1.9.3 HGW/QHW

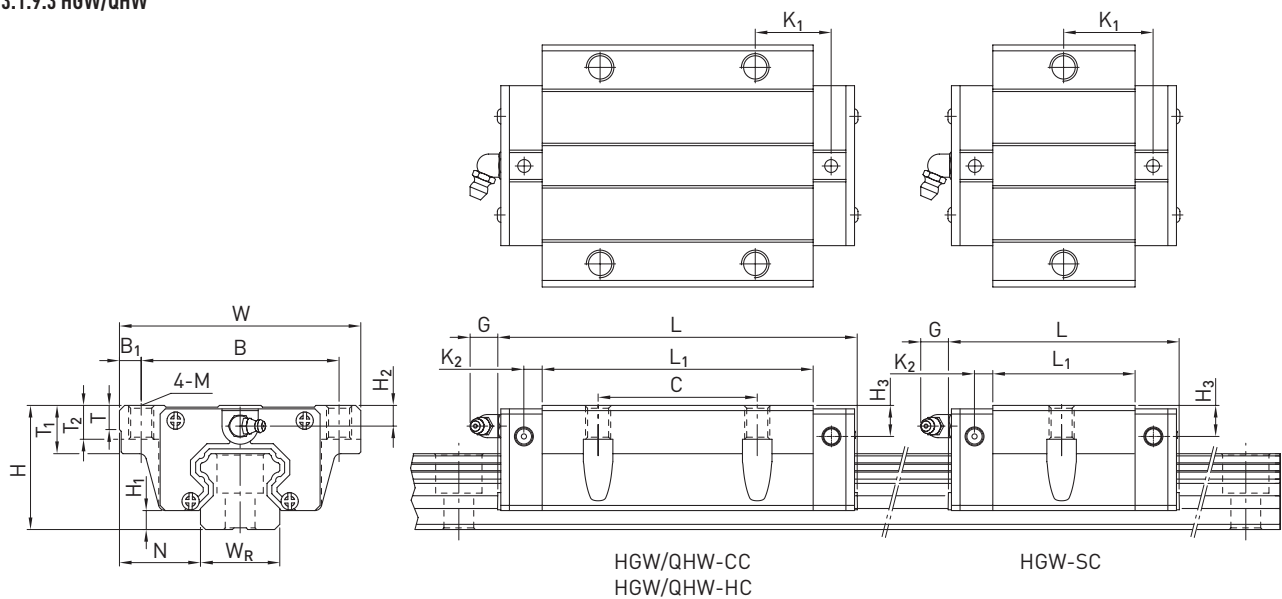

Table 3.8 Dimensions of the block

| Series/size | Installation dimensions [mm] | | | Dimensions of the block [mm] | | | | | | | | | | | | | | | Load ratings [N] | | Weight [kg] |
|-------------|------------------------------|----------------|------|------------------------------|-----|----------------|-------|---------------------|--------------------|----------------|----------------|-----|------|------|----------------|----------------|----------------|----------------|------------------|----------------|-------------|
| | H | H ₁ | N | W | B | B ₁ | C | L ₁ | L | K ₁ | K ₂ | M | G | T | T ₁ | T ₂ | H ₂ | H ₃ | C _{dyn} | C ₀ | |
| HGW15CC | 24 | 4.3 | 16.0 | 47 | 38 | 4.5 | 30 | 39.4 | 61.4 | 8.00 | 4.85 | M5 | 5.3 | 6.0 | 8.9 | 7.0 | 3.95 | 3.7 | 14,700 | 23,470 | 0.17 |
| QHW15CC | 24 | 4.0 | 16.0 | 47 | 38 | 4.5 | 30 | 39.4 | 61.4 | 8.00 | 5.00 | M5 | 5.3 | 6.0 | 8.9 | 7.0 | 3.95 | 4.2 | 17,940 | 19,860 | 0.17 |
| HGW20SC | 30 | 4.6 | 21.5 | 63 | 53 | 5.0 | — | 29.5 | 54.3 | 19.65 | 6.00 | M6 | 12.0 | 8.0 | 10.0 | 9.5 | 6.00 | 6.0 | 16,840 | 22,570 | 0.28 |
| HGW20CC | | | | | | | 40 | 50.5 | 77.5 | 10.25 | | | | | | | | | 27,100 | 36,680 | 0.40 |
| HGW20HC | | | | | | | 65.2 | 92.2 | 17.60 | 32,700 | | | | | | | | | 47,960 | 0.52 | |
| QHW20CC | 30 | 4.6 | 21.5 | 63 | 53 | 5.0 | 40 | 50.5 | 76.7 | 9.75 | 6.00 | M6 | 12.0 | 8.0 | 10.0 | 9.5 | 6.00 | 6.0 | 30,000 | 33,860 | 0.40 |
| QHW20HC | | | | | | | 65.2 | 91.4 | 17.10 | 35,700 | | | | | | | | | 42,310 | 0.52 | |
| HGW25SC | 36 | 5.5 | 23.5 | 70 | 57 | 6.5 | — | 38.2 | 64.2 | 23.20 | 6.00 | M8 | 12.0 | 8.0 | 14.0 | 10.0 | 6.00 | 5.0 | 26,930 | 36,560 | 0.42 |
| HGW25CC | | | | | | | 45 | 58.0 | 84.0 | 10.70 | | | | | | | | | 34,900 | 52,820 | 0.59 |
| HGW25HC | | | | | | | 78.6 | 104.6 | 21.00 | 42,200 | | | | | | | | | 69,070 | 0.80 | |
| QHW25CC | 36 | 5.5 | 23.5 | 70 | 57 | 6.5 | 45 | 58.0 | 83.4 | 10.70 | 6.00 | M8 | 12.0 | 8.0 | 14.0 | 10.0 | 6.00 | 5.0 | 41,900 | 48,750 | 0.59 |
| QHW25HC | | | | | | | 78.6 | 104.0 | 21.00 | 50,610 | | | | | | | | | 60,940 | 0.80 | |
| HGW30CC | 42 | 6.0 | 31.0 | 90 | 72 | 9.0 | 52 | 70.0 | 97.4 ¹⁾ | 14.25 | 6.00 | M10 | 12.0 | 8.5 | 16.0 | 10.0 | 6.50 | 10.8 | 48,500 | 71,870 | 1.09 |
| HGW30HC | | | | | | | 93.0 | 120.4 ²⁾ | 25.75 | 58,600 | | | | | | | | | 93,990 | 1.44 | |
| QHW30CC | 42 | 6.0 | 31.0 | 90 | 72 | 9.0 | 52 | 70.0 | 97.4 | 13.50 | 6.25 | M10 | 12.0 | 8.5 | 16.0 | 10.0 | 6.50 | 6.0 | 58,260 | 66,340 | 1.09 |
| QHW30HC | | | | | | | 93.0 | 120.4 | 25.75 | 70,320 | | | | | | | | | 88,450 | 1.44 | |
| HGW35CC | 48 | 7.5 | 33.0 | 100 | 82 | 9.0 | 62 | 80.0 | 112.4 | 14.60 | 7.00 | M10 | 12.0 | 10.1 | 18.0 | 13.0 | 9.00 | 12.6 | 64,600 | 93,990 | 1.56 |
| HGW35HC | | | | | | | 105.8 | 138.2 | 27.50 | 77,900 | | | | | | | | | 122,770 | 2.06 | |
| QHW35CC | 48 | 7.5 | 33.0 | 100 | 82 | 9.0 | 62 | 80.0 | 113.6 | 13.00 | 7.50 | M10 | 12.0 | 10.1 | 18.0 | 13.0 | 8.50 | 6.5 | 78,890 | 86,660 | 1.56 |
| QHW35HC | | | | | | | 105.8 | 139.4 | 25.90 | 95,230 | | | | | | | | | 115,550 | 2.06 | |
| HGW45CC | 60 | 9.5 | 37.5 | 120 | 100 | 10.0 | 80 | 97.0 | 139.4 | 13.00 | 10.00 | M12 | 12.9 | 15.1 | 22.0 | 15.0 | 8.50 | 20.5 | 103,800 | 146,710 | 2.79 |
| HGW45HC | | | | | | | 128.8 | 171.2 | 28.90 | 125,300 | | | | | | | | | 191,850 | 3.69 | |
| QHW45CC | 60 | 9.2 | 37.5 | 120 | 100 | 10.0 | 80 | 97.0 | 139.4 | 13.00 | 10.00 | M12 | 12.9 | 15.1 | 22.0 | 15.0 | 8.50 | 10.0 | 119,400 | 135,420 | 2.79 |
| QHW45HC | | | | | | | 128.8 | 171.2 | 28.90 | 144,130 | | | | | | | | | 180,560 | 3.69 | |
| HGW55CC | 70 | 13.0 | 43.5 | 140 | 116 | 12.0 | 95 | 117.7 | 166.7 | 17.35 | 11.00 | M14 | 12.9 | 17.5 | 26.5 | 17.0 | 12.00 | 19.0 | 153,200 | 211,230 | 4.52 |
| HGW55HC | | | | | | | 155.8 | 204.8 | 36.40 | 184,900 | | | | | | | | | 276,230 | 5.96 | |
| HGW65CC | 90 | 15.0 | 53.5 | 170 | 142 | 14.0 | 110 | 144.2 | 200.2 | 23.10 | 14.00 | M16 | 12.9 | 25.0 | 37.5 | 23.0 | 15.00 | 15.0 | 213,200 | 287,480 | 9.17 |
| HGW65HC | | | | | | | 203.6 | 259.6 | 52.80 | 277,800 | | | | | | | | | 420,170 | 12.89 | |

¹⁾ 98.8 for type SE; ²⁾ 121.8 for type SE

For dimensions of the rail, see Page 41, for standard as well as optional lubrication adapter see Page 150.